



7 The Terrace Raymond Terrace NSW

3  1  2 

This 3 bedroom brick & tile residence is located in a tranquil cul- de-sac and a 350 metre walk to grab your morning coffee.

Features:

- 3 bedrooms, built-in robes in 2
- Formal lounge and dining area
- Stylish kitchen with overhead cabinetry & dishwasher
- Casual dining and family room with RC/AC
- Main bathroom with separate toilet
- Double lock up garage with drive through access
- Large covered entertaining area, good size fully fenced yard & established fruit trees
- Lots of bonuses here too - Plantation shutters, ceiling fans, natural gas & lawnlocker

A 350 metre walk to Anytime Fitness & Foodary

Price : \$ 575,000
Land Size : 621 sqm
View : <https://www.dowlingterrace.com.au/sale/now/port-stephens/raymond-terrace/residential/house/7633240>



Kim Hammond
0498 990 064

Site Plan
Back



Front

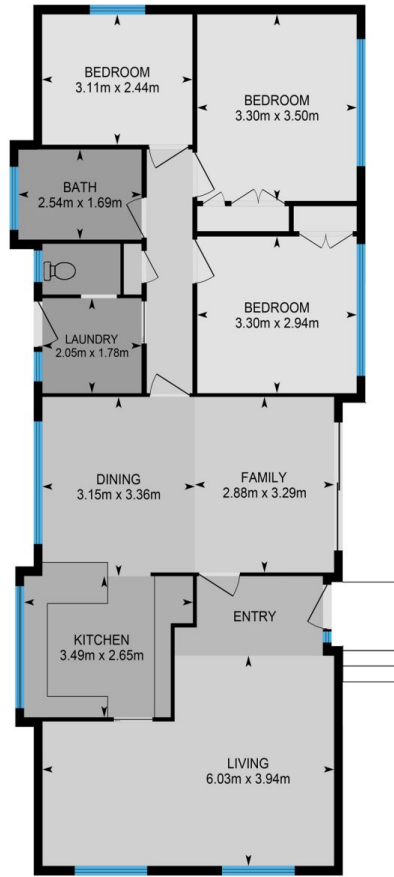

Measurements are approximate
and are to be used only as a guide

