



## 31 Mount Hall Road Raymond Terrace NSW

2 1 2

Welcome to 31 Mount Hall Road. A 2-bedroom, 1-bathroom home, offering an incredible opportunity for renovators and investors. Situated on a generous plot with ample space for potential expansion or redevelopment. (Subject to council approval from Port Stephens Council)

**Price** : \$ 416,000  
**Land Size** : 669 sqm  
**View** : <https://www.dowlingterrace.com.au/sale/nsw/port-stephens/raymond-terrace/residential/house/7814587>

### Key Features:

- ? Two bedrooms, one bathroom, layout perfect for a renovation project.
- ? Double garage. Convenient parking for multiple vehicles or potential expansion possibilities.
- ? Spacious block with ample room for extension, landscaping, or creative development.
- ? Enclosed sunroom

Situated in a great location close to school and shops, offering convenience and potential for increased property



**Liam Higgins**  
0423 832 732



**Kim Hammond**  
0498 990 064

Measurements are approximate  
and are to be used only as a guide

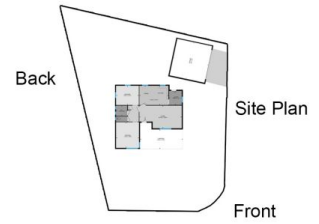
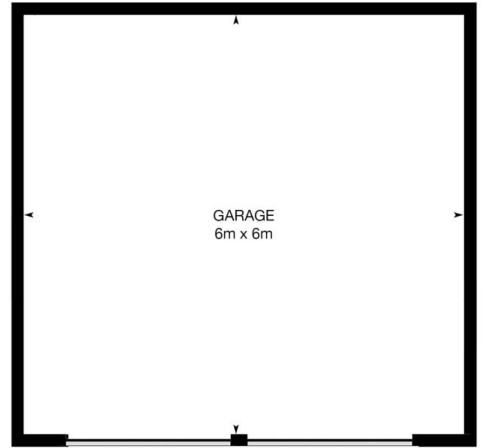

**DOWLING**  
PROPERTY

31 Mount Hall Road, Raymond Terrace