

DOWLING

PROPERTY



1 & 1A Kinross Street Raymond Terrace NSW

5 2 3

Live in one and rent the other. Or continue to rent both out, currently achieving a robust rental return of \$930 per week.

A smartly renovated brick and tile three-bedroom house as well as a modern 2 bedroom home positioned on a corner block, offering excellent access points and space to both homes.

1: Enjoy a spacious living, dining, and kitchen area with corner windows allowing natural light with reverse cycle air conditioning.

Three generously sized bedrooms share use of the updated bathroom and combined laundry. The fully fenced backyard is a blank canvas for your outdoor vision, with ample room for children and pets to play.

Benefit from a double carport, large storage shed and backyard access for your caravan, boat, or trailer.

Price : \$840,000 - \$870,000

Land Size : 651 sqm

View : <https://www.dowlingterrace.com.au/sale/ns-w/port-stephens/raymond-terrace/residential/house/7840181>



Kim Hammond
0498 990 064



Liam Higgins
0423 832 732



Measurements are approximate and are to be used only as a guide

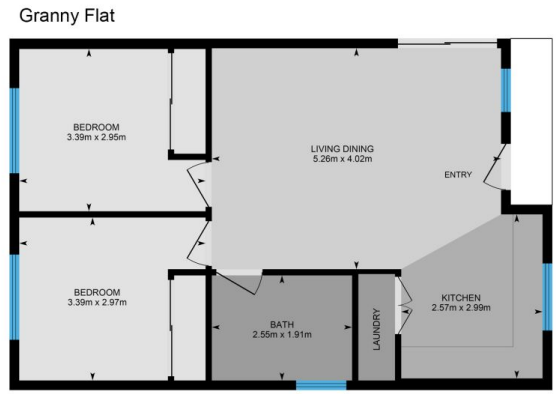

DOWLING
PROPERTY

1 Kinross Street, Raymond Terrace