



2 Purcell Street Raymond Terrace NSW

3 1 2

Welcome to 2 Purcell St, a delightful residence that seamlessly blends classic charm with modern conveniences. This three-bedroom gem is sure to capture your heart with its well-maintained features and thoughtful design.

Key Features:

Tiled entry
3 spacious bedrooms, each equipped with built-in robes and plush carpeting in impeccable condition.
The main bedroom boasts ensuite access to a 3-way bathroom.
Formal lounge room and dining area with beautiful timber flooring that adds warmth to the space.
The U-shaped kitchen is the heart of the home.
Revel in the spaciousness of the large living room

Price : \$ 670,001
Land Size : 597 sqm
View : <https://www.dowlingterrace.com.au/sale/nsw/port-stephens/raymond-terrace/residential/house/7863335>



Gregg Bates
0418 416 343



Kim Hammond
0498 990 064

Measurements are approximate
and are to be used only as a guide

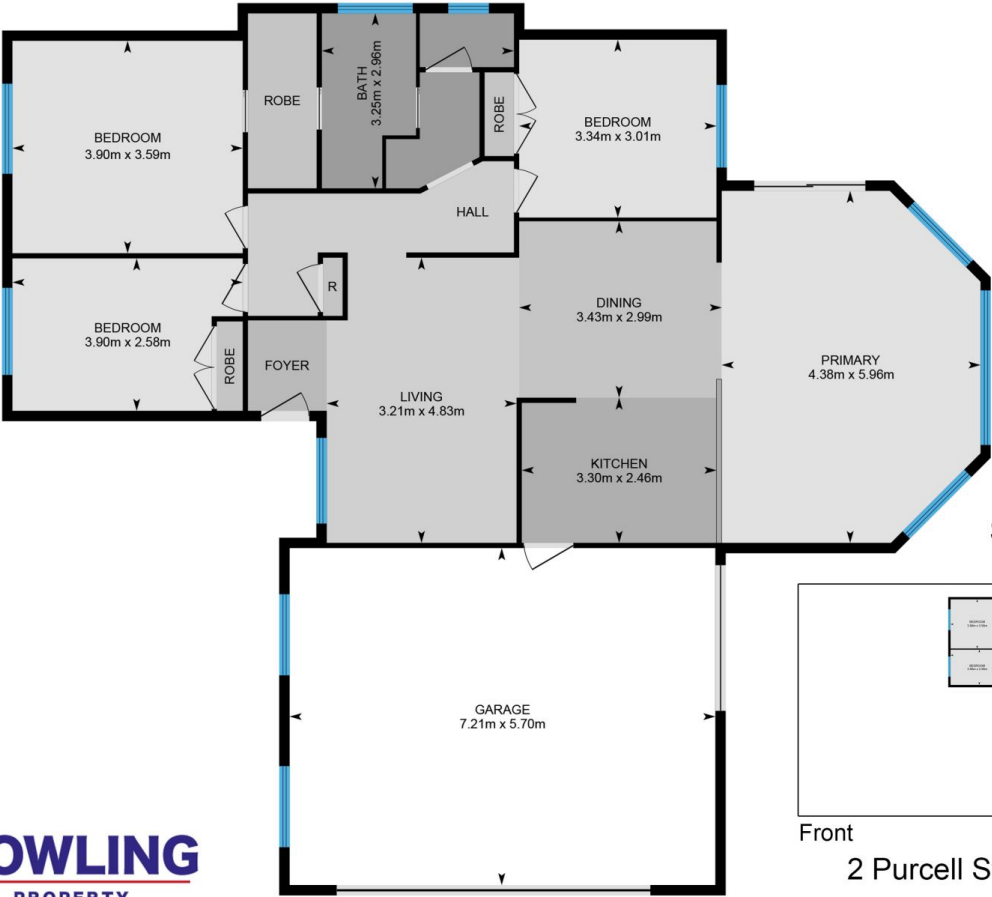

Site Plan
Back



Front
2 Purcell St, Raymond Terrace