

# DOWLING

## PROPERTY



### 31 Bareena Street Raymond Terrace NSW

3  1  1 

Offering the perfect blend of comfort and style, this stylish, renovated home is perfect for first home buyers or someone wanting to utilize the vast block of land for potential dual occupancy (pending council approval). In a prime location close to Raymond Terrace CBD, schools and parks, the possibilities on this one are endless.

**Price** : \$590,000 - \$630,000  
**Land Size** : 702 sqm  
**View** : <https://www.dowlingterrace.com.au/sale/now/port-stephens/raymond-terrace/residential/house/7957476>

#### Key Features:

- 2 bedrooms with built-in robes, 1 bedroom/office, air-conditioning & ceiling fans for year-round comfort.
- Beautifully renovated bathroom, experience luxury and sophistication.
- Spacious living area with floorboards & ceiling fans. Perfect for relaxation and entertainment.
- Inviting dining area opening onto large undercover deck. Ideal for alfresco dining and gatherings.



**Liam Higgins**  
0423 832 732



**Kim Hammond**  
0498 990 064

<https://www.dowlingterrace.com.au>

Measurements are approximate and are to be used only as a guide

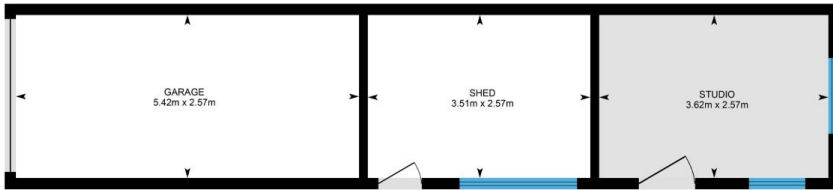

Site Plan



**DOWLING**  
PROPERTY

31 Bareena Street, Raymond Terrace