



29 Pennington Street Raymond Terrace NSW

3 1 1

Welcome to 29 Pennington Street. This 3 bedroom brick home is perfect for first home buyers wanting to get into the market and add their own special touch or for a savvy investor chasing a good return. Situated in a quiet, popular neighborhood close to parks, shops, schools and fields, at this price range its one you don't want to miss.

Price : \$580,000-\$600,000
Land Size : 557 sqm
View : <https://www.dowlingterrace.com.au/sale/nsw/port-stephens/raymond-terrace/residential/house/7984538>

Key Features:

- Three bedrooms all offering built ins and ceiling fans
- Spacious living area with ceiling fan
- Kitchen with loads of potential and plenty of storage
- Dining room off kitchen
- Bathroom with separate toilet and bathtub
- External laundry
- Large fully fenced yard with Garden shed
- Sheltered Car Port



Liam Higgins
0423 832 732



Kim Hammond
0498 990 064

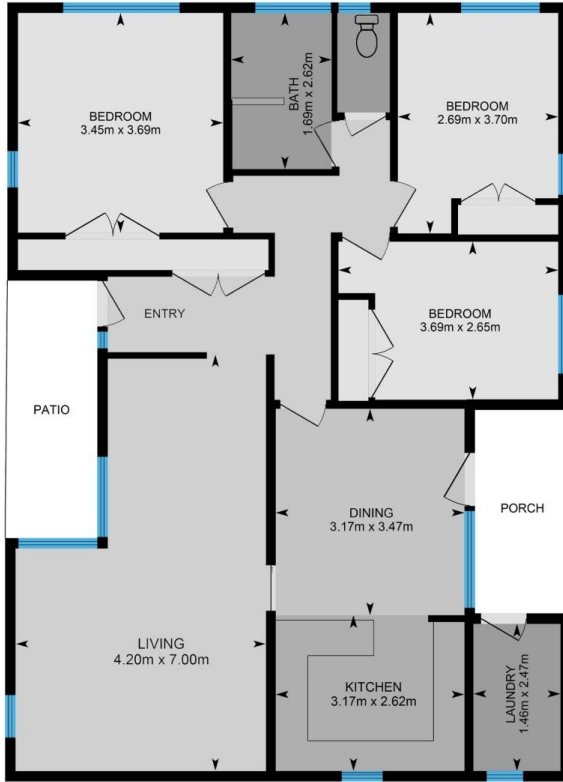

Measurements are approximate and are to be used only as a guide

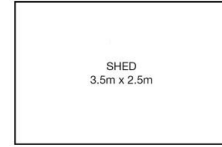
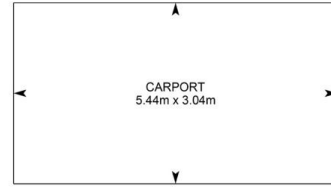

DOWLING
PROPERTY

29 Pennington Street, Raymond Terrace