

# DOWLING

## PROPERTY



### 11/4 Mosman Place Raymond Terrace NSW

2  1  1 

Discover the ultimate blend of comfort and convenience in this light-filled 2-bedroom low maintenance townhouse. Enjoy a spacious living room with reverse cycle A/C that opens to a paved, fenced courtyard-perfect for relaxation.

**Price** : \$ 455,000

**View** : <https://www.dowlingterrace.com.au/sale/nsw/port-stephens/raymond-terrace/residential/unit/8138536>

#### Features:

- \* The huge master bedroom and second bedroom both have updated mirrored built-in wardrobes, reverse cycle A/C and ceiling fans.
- \* The renovated kitchen boasts a walk-in pantry, stainless steel appliances including self-cleaning oven, induction stove, rangehood, dishwasher and full double sink.
- \* Both the bathroom with floor to ceiling tiles and laundry with 2nd toilet are fully renovated, providing modern amenities.
- \* Tiled floors downstairs providing easy maintenance & wool carpet upstairs for added comfort.



**Kim Hammond**  
0498 990 064



**Liam Higgins**  
0423 832 732

Measurements are approximate  
and are to be used only as a guide

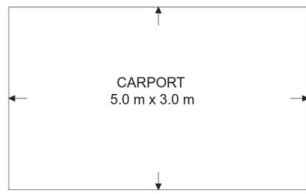

Lower Level

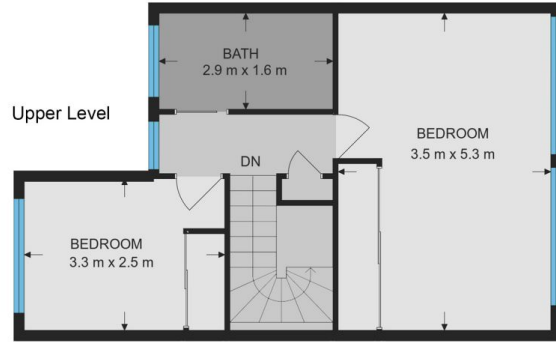
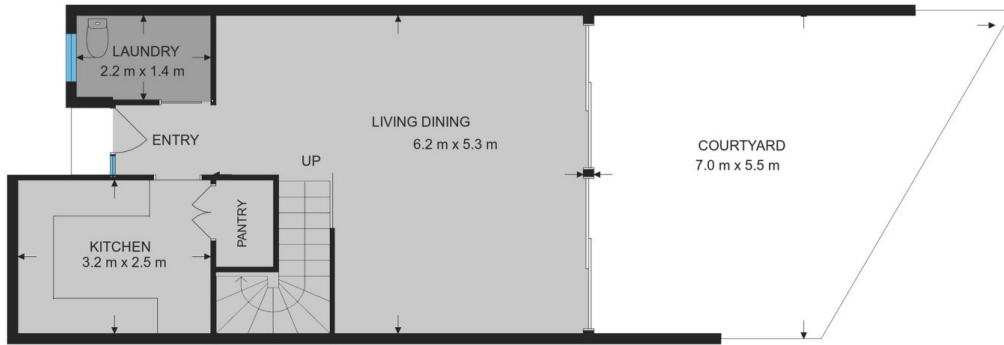

**DOWLING**  
PROPERTY

11/4 Mosman Place, Raymond Terrace