

# DOWLING

PROPERTY



## 59 Dawson Road Raymond Terrace NSW

4  2  2 

Welcome to 59 Dawson Road, a spacious and modern family home set in the sought-after Riverview Ridge Estate, just 3.2 km north of Raymond Terrace CBD.

Features Include:

? 4 generously sized bedrooms, each with built-in robes and ceiling fans

? Master suite with a walk-in robe and bright, modern ensuite

? Spacious lounge and dining areas perfect for family gatherings

? Contemporary galley kitchen with stainless steel appliances, including a dishwasher and appliance cupboard, opening to an additional living area and rumpus room

? Combined bathroom with bath & separate shower

? Plantation shutters, ducted air-conditioning and ceiling fans throughout for year-round comfort

**Price** : \$790,000 - \$820,000

**Land Size** : 687 sqm

**View** : <https://www.dowlingterrace.com.au/sale/nsw/port-stephens/raymond-terrace/residential/house/8166872>



**Kim Hammond**  
0498 990 064



**Liam Higgins**  
0423 832 732

<https://www.dowlingterrace.com.au>

Measurements are approximate  
and are to be used only as a guide

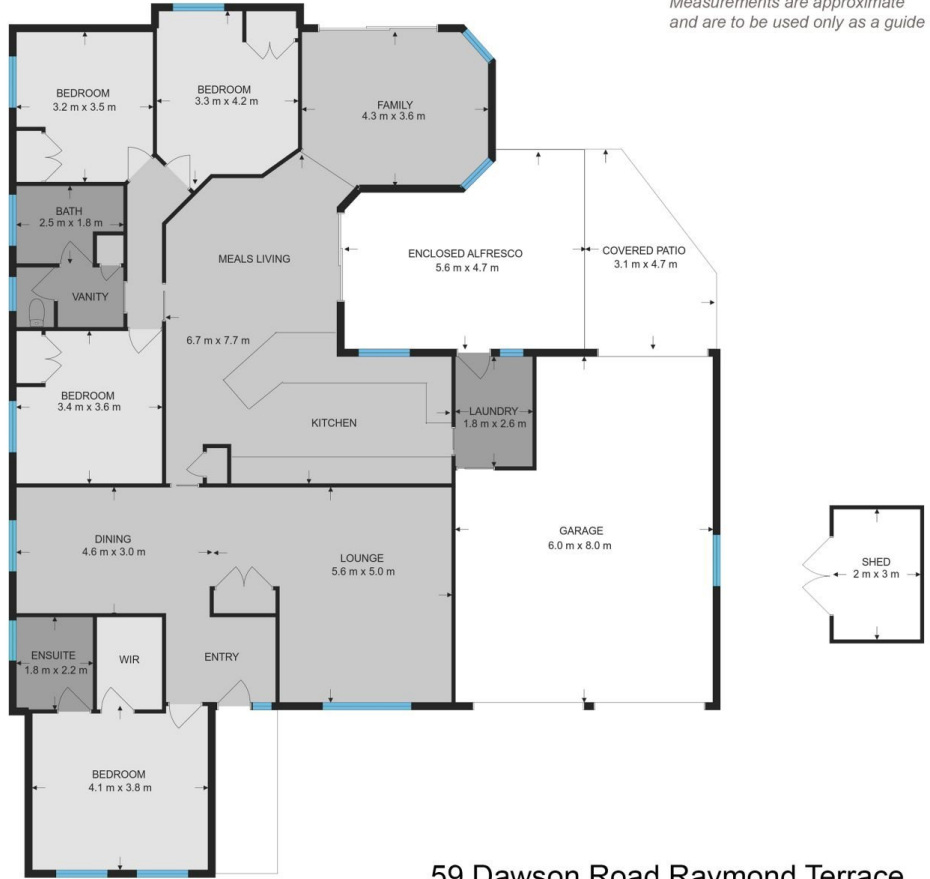

**DOWLING**  
PROPERTY

59 Dawson Road Raymond Terrace