



23 Hastings Drive Raymond Terrace NSW

4 1 3

Comfort and convenience are equally matched in this beautifully renovated home, just a short walk from Grahamstown Public School and the Lakeside Village shops and tavern.

With every detail thoughtfully upgraded, this four-bedroom home offers a spacious single-level design, complete with two separate living areas that give everyone room to unwind. The neutral colour scheme is complemented by the natural warmth of timber floors and the sophistication of plantation shutters. Ducted air-conditioning keeps things comfortable year-round, while 20 solar panels help keep energy costs low. Step outside to a spacious 40sqm deck with a stunning cathedral roof and ceiling fan that will be your go-to spot for alfresco entertaining. Its north-facing orientation floods the space with winter sunshine, making it a cosy retreat in cooler months. Practicality meets style

Price : \$ 735,000
Land Size : 641.3 sqm
View : <https://www.dowlingterrace.com.au/sale/nsw/port-stephens/raymond-terrace/residential/house/8189193>



Liam Higgins
0423 832 732



Kim Hammond
0498 990 064

Measurements are approximate and are to be used only as a guide

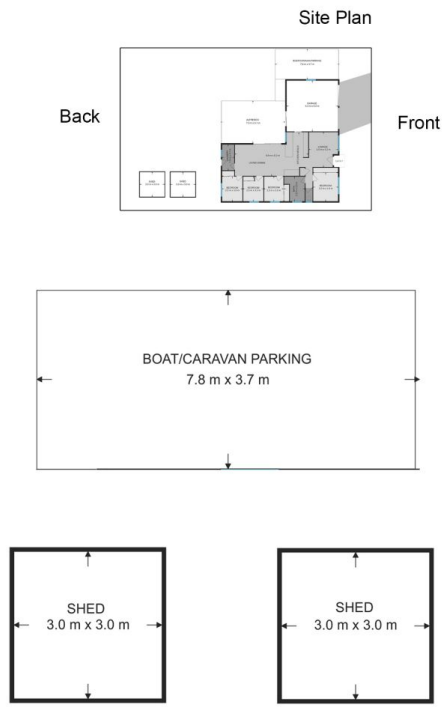

DOWLING
PROPERTY

23 Hastings Drive, Raymond Terrace